

UNAUTHORIZED USE OF THIS
DRAWING IS STRICTLY PROHIBITED

| DAR | REV | DESCRIPTION | APPVD | DATE |
|------|-----|-----------------|-------|------|
| 1785 | A | INITIAL RELEASE | DG | 3-09 |
| 1940 | B | SEE DAR | DG | 6-09 |

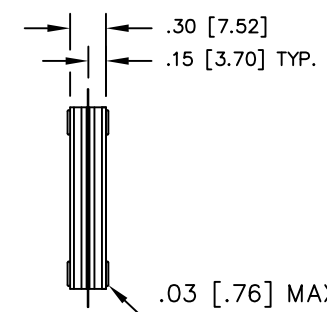
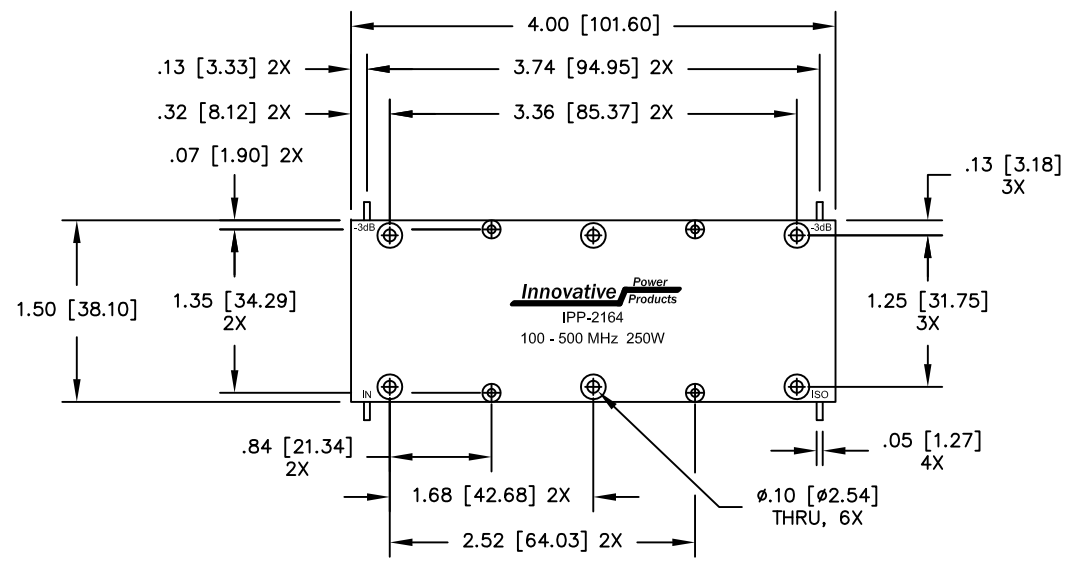

.03 [.76] MAX. EYELET PROJECTION
.22 [5.58] MAX. EYELET DIA.
(6X EACH SIDE, LARGE EYELETS)
.03 [.76] MAX. EYELET PROJECTION
.15 [3.94] MAX. EYELET DIA.
(4X EACH SIDE, SMALL EYELETS)

NOTES

1. LEAD MATERIAL: 99.99% PURE SILVER, .005 [25.4] THICK X .15 [3.81] MIN. LONG.
2. SEE 90° APPLICATION NOTE FOR FURTHER INFORMATION.
3. RoHS COMPLIANT.

ELECTRICAL SPECIFICATIONS

FREQUENCY: 100 - 500 MHz.
INSERTION LOSS: < 0.50 dB
VSWR: < 1.30:1
ISOLATION: > 16 dB
AMPLITUDE BALANCE: ±0.75 dB
PHASE BALANCE: ±5°
POWER: 250 WATT
TEMPERATURE: -55°C TO 85°C

| | | | | | | | |
|--|------------------|-----|-------|------|---|-----|----------|
| MATERIAL AL. ALLOY, 6061-T6 | DWN | DG | DATE | 3-09 | Innovative Power Products | | |
| | ENG | TJD | DATE | 3-09 | | | |
| FINISH CHEM FILM, CLEAR, PER MIL-DTL-5541, TYPE 2, REV. F, CLASS 3 (ROHS COMPLIANT) | MANUF | TP | DATE | 3-09 | TITLE OUTLINE, COUP., 90°, 100 - 500 MHz. 250W | | |
| | CAGE CODE: 437R2 | | | | SIZE | P/N | IPP-2164 |
| TOLERANCE .XX ±.02 [.50] .XXX ±.005 [.127] ANG. ±1/2° | SHEET | OF | SCALE | 2:1 | | | |
| | 1 | 1 | | | | | |