

UNAUTHORIZED USE OF THIS
DRAWING IS STRICTLY PROHIBITED

| DAR | REV | DESCRIPTION | APPVD | DATE |
|------|-----|-----------------|-------|-------|
| 1234 | A | INITIAL RELEASE | TJD | 11-06 |

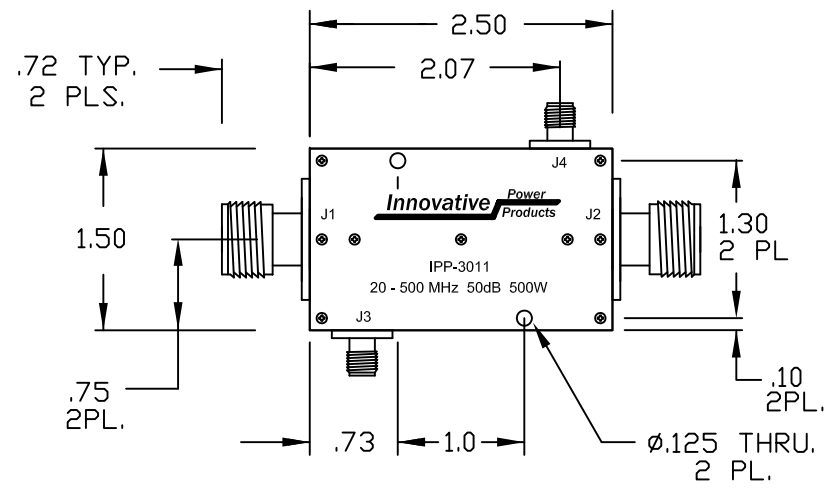

NOTES

- CONNECTOR TYPE J1 - J2: TYPE "N" FEMALE
J3 - J4: TYPE "SMA" FEMALE

ELECTRICAL SPECIFICATIONS

| | |
|-------------------|---------------|
| FREQUENCY: | 20 - 500 MHz. |
| INSERTION LOSS: | 0.30 dB MAX. |
| VSWR: | 1.25:1 MAX. |
| COUPLING: | 50.0 ±1.0dB |
| DIRECTIVITY: | >20dB |
| COUPLED FLATNESS: | ±0.50dB MAX. |
| POWER: | 500 WATT |

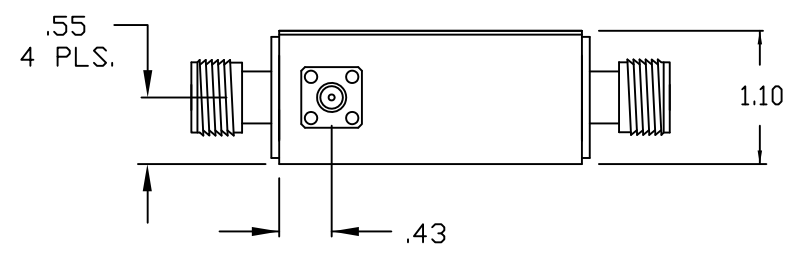

| | | | | |
|---|------------------|--------------|--|-----------|
| MATERIAL AL. ALLOY 6061-T651 | DWN DG | DATE 11-06 | | |
| | ENG TJD | DATE 11-06 | | |
| FINISH CHEM FILM CLEAR IRRIDITE | MANUF TP | DATE 11-06 | TITLE DUAL DIRECTIONAL COUPLER 20 - 500 MHz. 500 WATT, 50 dB | |
| | CAGE CODE: 437R2 | | | |
| TOLERANCE .XX ±.02 .XXX ±.005 ANG. ±1/2° | SHEET OF 1 1 | SCALE 2:1 | P/N IPP-3011 | REV. A |