

UNAUTHORIZED USE OF THIS  
DRAWING IS STRICTLY PROHIBITED

DAR	REV	DESCRIPTION	APPVD	DATE
1150	A	INITIAL RELEASE	TJD	7-06
1544	B	CHANGE LD HEIGHT & HEIGHT DIMS	DG	9-08
1865	C	SEE DAR	DG	5-09

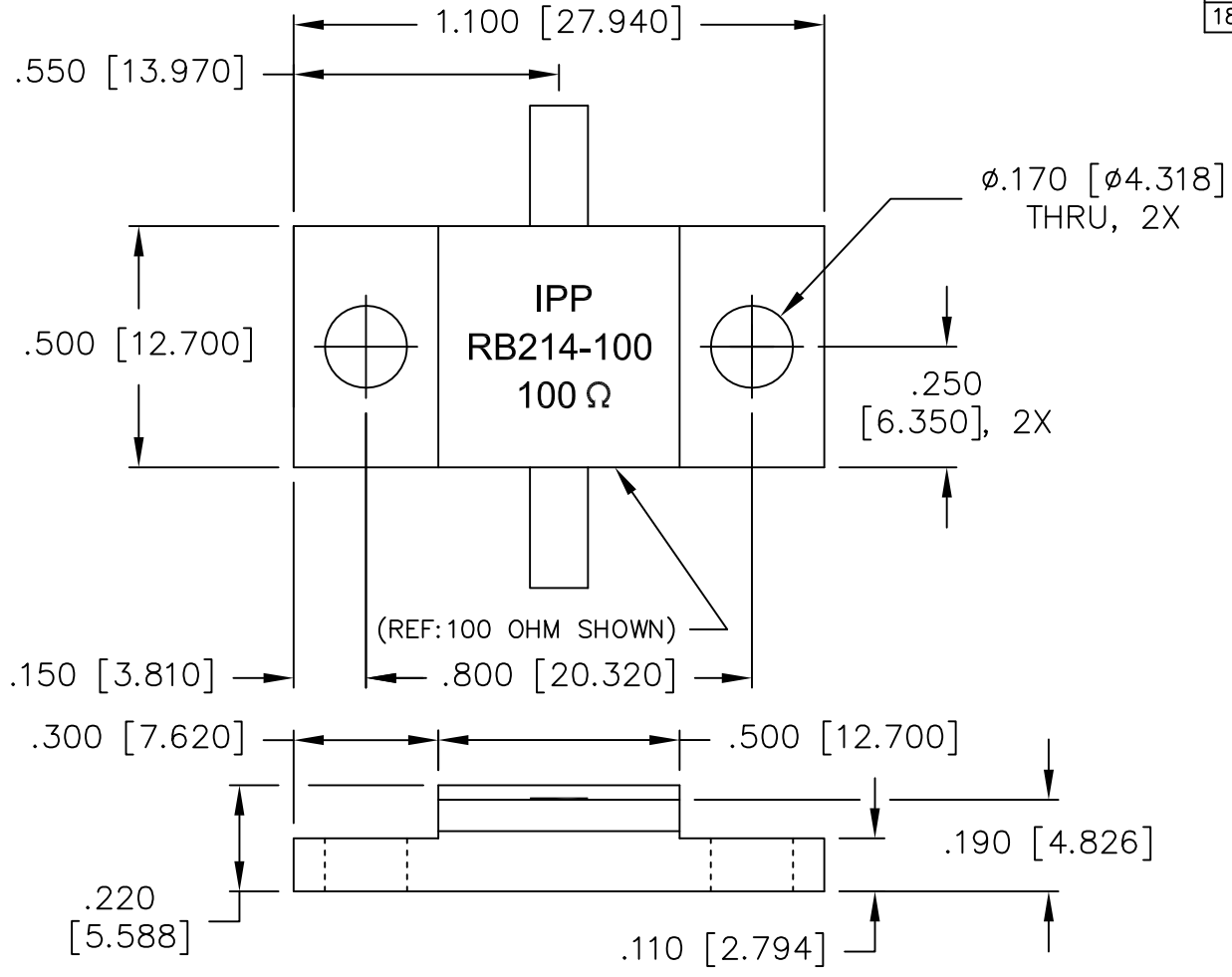

- NOTES:**
- LEAD MATERIAL: 99.99% PURE SILVER, .120 [3.048] WIDE x .005 [.127] THICK x .250 [6.350] MIN. LONG.
  - SUBSTRATE MATERIAL: BeO  
COVER MATERIAL: Al<sub>2</sub>O<sub>3</sub>
  - FLANGE MATERIAL: COPPER  
PLATING: NICKEL
  - LEAD(S) WELDED TO SUBSTRATE.

ELECTRICAL SPECIFICATIONS

INPUT POWER: 400 WATT  
 FREQUENCY: DC - 1.0 GHZ.  
 CAPACITANCE: 6 pF

POWER DERATING CURVE

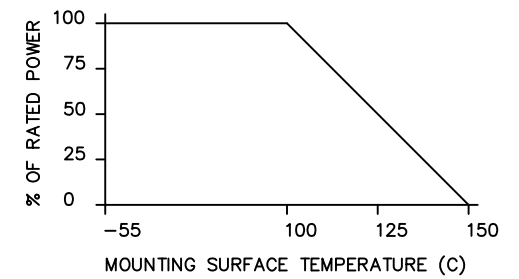

PART NO.	VALUE	TOLERANCE
IPP-RB214-50	50 OHMS	+/- 5%
IPP-RB214-100	100 OHMS	+/- 5%

MATERIAL [2] [3]	DWN DG	DATE 7-06	
	ENG TJD	DATE 7-06	
FINISH [3]	MANUF TP	DATE 7-06	
TOLERANCE .XX ±.02 [.50] IN [MM] .XXX ±.010 [.254]	CAGE CODE: 437R2		P/N IPP-RB214-XXX
	SHEET OF 1 1	SCALE 4:1	