

UNAUTHORIZED USE OF THIS
DRAWING IS STRICTLY PROHIBITED

DAR	REV	DESCRIPTION	APPVD	DATE
1053	A	INITIAL RELEASE	TJD	1-06
1221	B	REVISE SPECIFICATIONS	TJD	10-06
1317	C	CHANGE TEMPERATURE TO 150 DEGREES	TP	7-07
1497	D	CHANGE FLANGE, LD HEIGHT & HEIGHT DIMS	DG	8-08

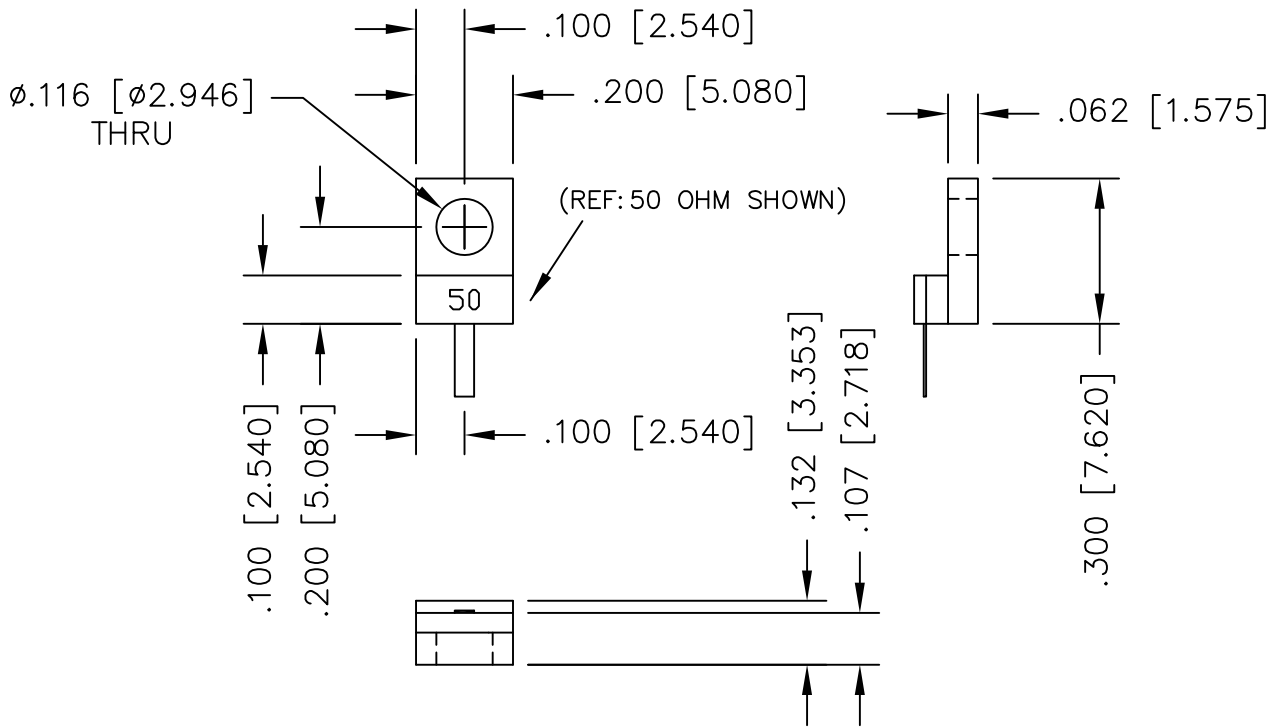

NOTES

- LEAD MATERIAL:
99.99% PURE SILVER,
.040 WIDE x .005 THICK
- LEAD LENGTH: .150 MIN.
- SUBSTRATE MATERIAL: BeO
COVER MATERIAL: Al₂O₃
- FLANGE MATERIAL: COPPER
PLATING: NICKEL
- DIMENSIONS: INCHES, [mm]

ELECTRICAL SPECIFICATIONS

INPUT POWER: 30 WATT
 FREQ: DC - 4.2 GHz.
 VSWR: 1.20:1 DC - 3 GHz.
 1.30:1 @ 4.2 GHz.

POWER DERATING CURVE

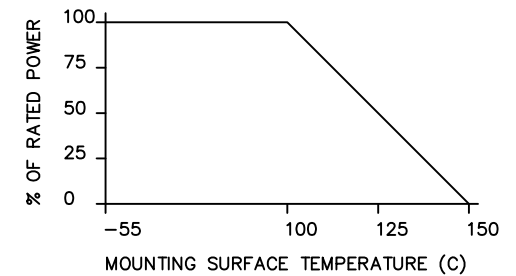

PART NO.	VALUE	TOLERANCE
IPP-TB201C-50	50 OHMS	+/- 5%
IPP-TB201C-100	100 OHMS	+/- 5%

MATERIAL [3] [4]	DWN DG	DATE 1/06			
	ENG TJD	DATE 1/06			
FINISH [4]	MANUF TP	DATE 1/06	TITLE TERMINATION, 30 WATT, HALF FLANGE		
	CAGE CODE: 437R2		SIZE B	P/N IPP-TB201C-XXX	REV. D
TOLERANCE IN [MM]	.XX ±.02 [.51] .XXX ±.010 [.254]	SHEET OF 1 1	SCALE 4:1		