

UNAUTHORIZED USE OF THIS  
DRAWING IS STRICTLY PROHIBITED

DAR	REV	DESCRIPTION	APPVD	DATE
1053	A	INITIAL RELEASE	TJD	1-06
1106	B	ADD COVER MATERIAL	TJD	5-06
1317	C	CHANGE TEMPERATURE TO 150 DEGREES	TP	7-07

**NOTES**

- LEAD MATERIAL:  
99.99% PURE SILVER,  
.040 WIDE x .005 THICK
- LEAD LENGTH: .150 MIN.
- 3 SUBSTRATE MATERIAL: BeO  
COVER MATERIAL: Al<sub>2</sub>O<sub>3</sub>
- 4 FLANGE MATERIAL: COPPER  
PLATING: NICKEL
- DIMENSIONS: INCHES, [mm]

ELECTRICAL SPECIFICATIONS

INPUT POWER: 30 WATT  
 FREQ: DC - 6.0 GHZ.  
 VSWR: 1.13:1 DC - 3 GHZ.  
 1.20:1 DC - 4 GHZ.  
 1.50:1 DC - 6 GHZ.

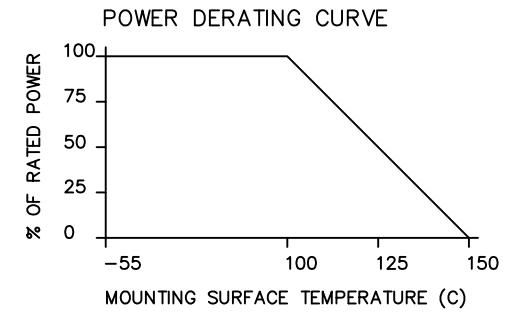
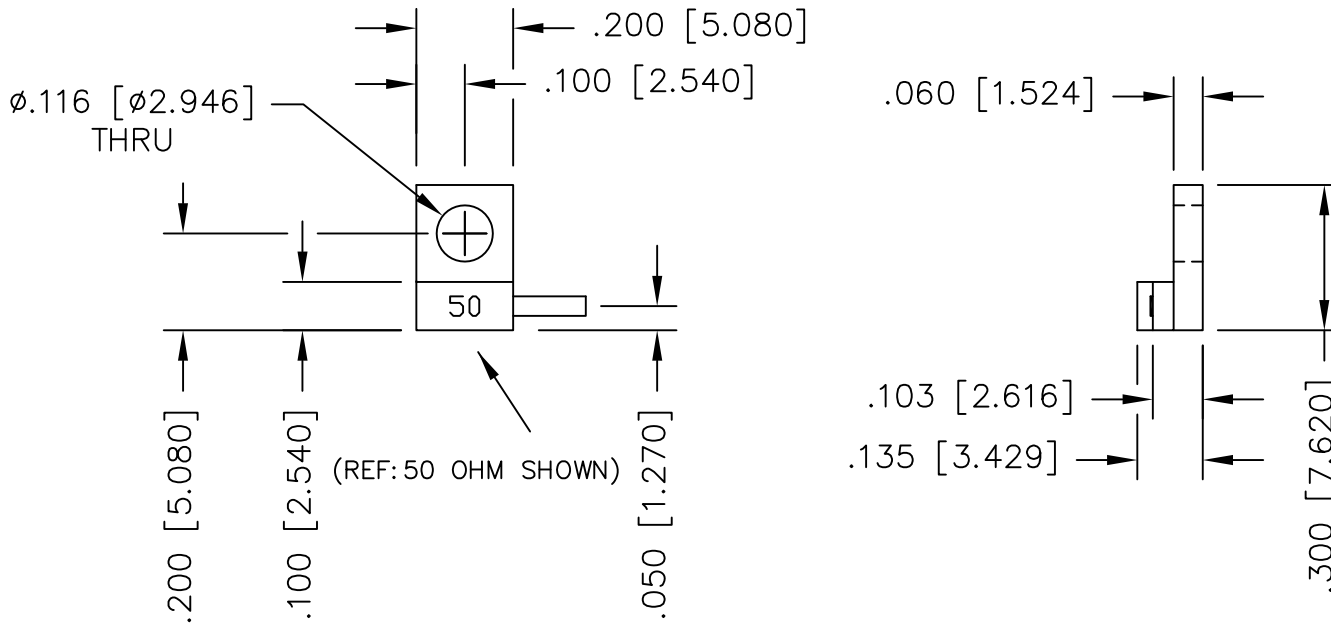

PART NO.	VALUE	TOLERANCE
IPP-TB201R-50	50 OHMS	+/- 5%
IPP-TB201R-100	100 OHMS	+/- 5%

MATERIAL	<span style="border: 1px solid black; padding: 0 2px;">3</span> <span style="border: 1px solid black; padding: 0 2px;">4</span>	DWN DG	DATE 1/06	<b>Innovative</b> <i>Power</i> <b>Products</b>
		ENG TJD	DATE 1/06	
FINISH	<span style="border: 1px solid black; padding: 0 2px;">4</span>	MANUF TP	DATE 1/06	
TOLERANCE		CAGE CODE: 437R2		
.XX ±.02 [.51] IN [MM] .XXX ±.010 [.254]		SHEET OF 1 1	SCALE 4:1	TITLE TERMINATION, 30 WATT, HALF FLANGE
SIZE B	P/N IPP-TB201R-XXX	REV. C		