

UNAUTHORIZED USE OF THIS  
DRAWING IS STRICTLY PROHIBITED

DAR	REV	DESCRIPTION	APPVD	DATE
1106	A	INITIAL RELEASE	TP	5-06
1147	B	REVISE FREQUENCY RANGE	TJD	6-06
1317	C	CHANGE TEMPERATURE TO 150 DEGREES	TP	7-07
1362	D	REVISED PART NUMBER	DG	11-07
1497	E	CHANGE LD HEIGHT & HEIGHT DIMS	DG	8-08
1824	F	SEE DAR	DG	4-09
2006	G	SEE DAR	DG	8-09
2570	H	SEE DAR	DG	7-10

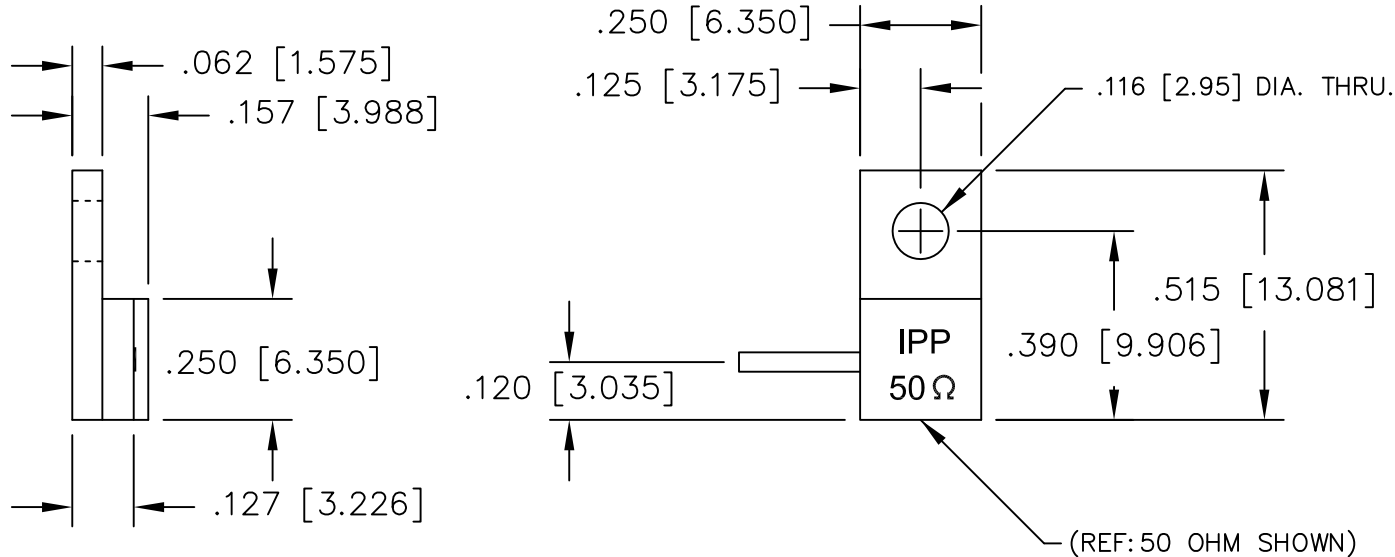

**NOTES:**

- LEAD MATERIAL: 99.99% PURE SILVER, .040 [1.016] WIDE x .005 [.127] THICK x .250 [6.350] MIN. LONG.
- SUBSTRATE MATERIAL: BeO  
COVER MATERIAL: Al<sub>2</sub>O<sub>3</sub>
- FLANGE MATERIAL: COPPER  
PLATING: NICKEL
- LEAD(S) WELDED TO SUBSTRATE.

ELECTRICAL SPECIFICATIONS

INPUT POWER: 50 WATT  
 FREQ: DC - 5.0 GHZ.  
 VSWR: 1.10:1 DC - 4.2 GHZ.  
 1.25:1 DC - 5 GHZ.

POWER DERATING CURVE

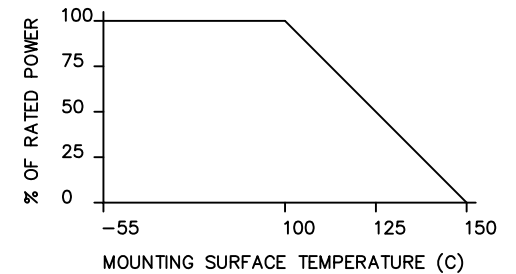

PART NO.	VALUE	TOLERANCE
IPP-TB203-50	50 OHMS	+/- 5%
IPP-TB203-100	100 OHMS	+/- 5%

MATERIAL [2] [3]	DWN DG	DATE 12/05	
	ENG TJD	DATE 12/05	
FINISH [3]	MANUF TP	DATE 12/05	
TOLERANCE .XX ±.02 [.51] IN [MM] .XXX ±.010 [.254]	CAGE CODE: 437R2		P/N IPP-TB203-XXX
	SHEET OF 1 1	SCALE 4:1	