

UNAUTHORIZED USE OF THIS
DRAWING IS STRICTLY PROHIBITED

DAR	REV	DESCRIPTION	APPVD	DATE
1106	A	INITIAL RELEASE	TP	5-06
1147	B	REVISE FREQUENCY RANGE	TJD	6-06
1317	C	CHANGE TEMPERATURE TO 150 DEGREES	TP	7-07
1497	D	CHANGE LD HEIGHT & HEIGHT DIMS	DG	8-08
1824	E	SEE DAR	DG	4-09

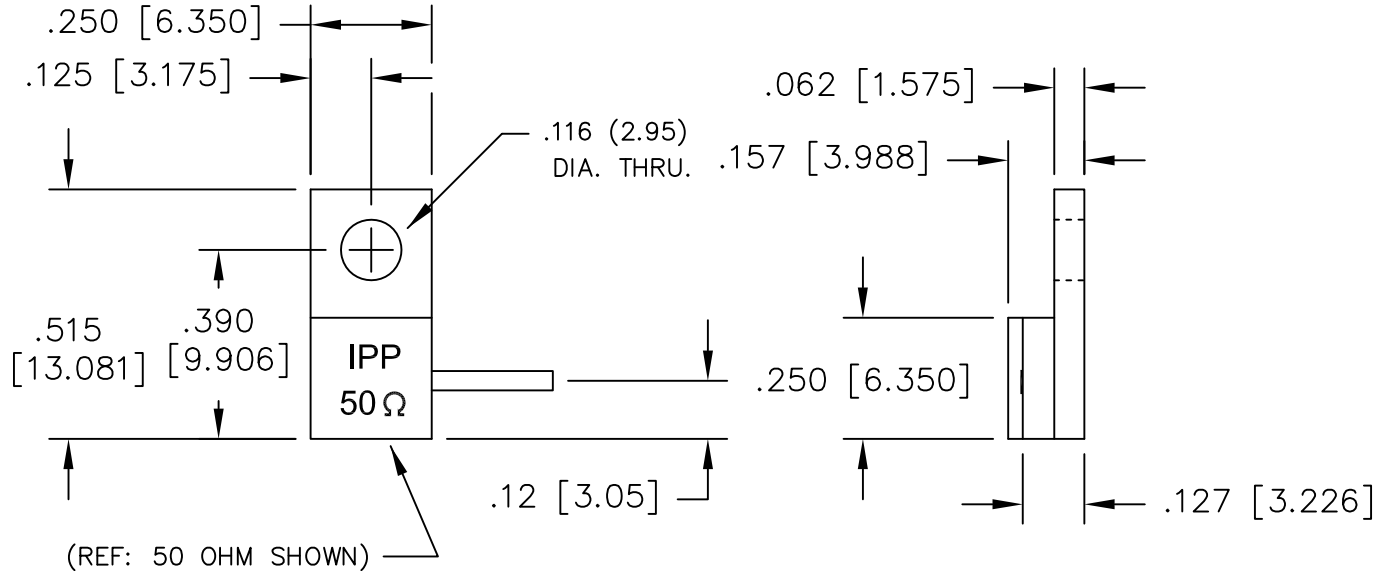

NOTES:

- LEAD MATERIAL: 99.99% PURE SILVER, .040 [1.016] WIDE x .005 [.127] THICK x .250 [6.350] MIN. LONG.
- SUBSTRATE MATERIAL: BeO
COVER MATERIAL: Al₂O₃
- FLANGE MATERIAL: COPPER
PLATING: NICKEL
- LEAD(S) WELDED TO SUBSTRATE.

ELECTRICAL SPECIFICATIONS

INPUT POWER: 50 WATT
 FREQ: DC - 5.0 GHZ.
 VSWR: 1.10:1 DC - 4.2 GHZ.
 1.25:1 DC - 5 GHZ.

POWER DERATING CURVE

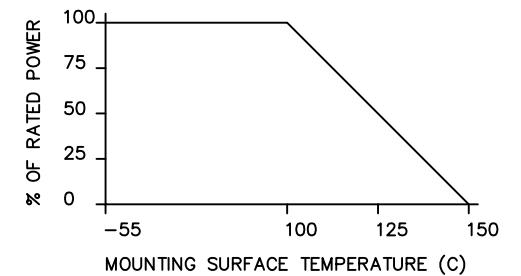

PART NO.	VALUE	TOLERANCE
IPP-TB203R-50	50 OHMS	+/- 5%
IPP-TB203R-100	100 OHMS	+/- 5%

MATERIAL	[2] [3]	DWN DG	DATE 5-06	Innovative Power Products	
FINISH	[3]	ENG TJD	DATE 5-06		
TOLERANCE	.XX ±.02 [.51] IN [MM] .XXX ±.010 [.254]	MANUF TP	DATE 5-06		
CAGE CODE: 437R2				TITLE	TERMINATION, 50 WATT, FLANGE
		SHEET OF 1 1	SCALE 4:1	P/N	IPP-TB203R-XXX
					REV. E