

UNAUTHORIZED USE OF THIS
DRAWING IS STRICTLY PROHIBITED

DAR	REV	DESCRIPTION	APPVD	DATE
1323	A	INITIAL RELEASE	TJD	8-07
1497	B	CHANGE LD HEIGHT & HEIGHT DIMS	DG	11-08

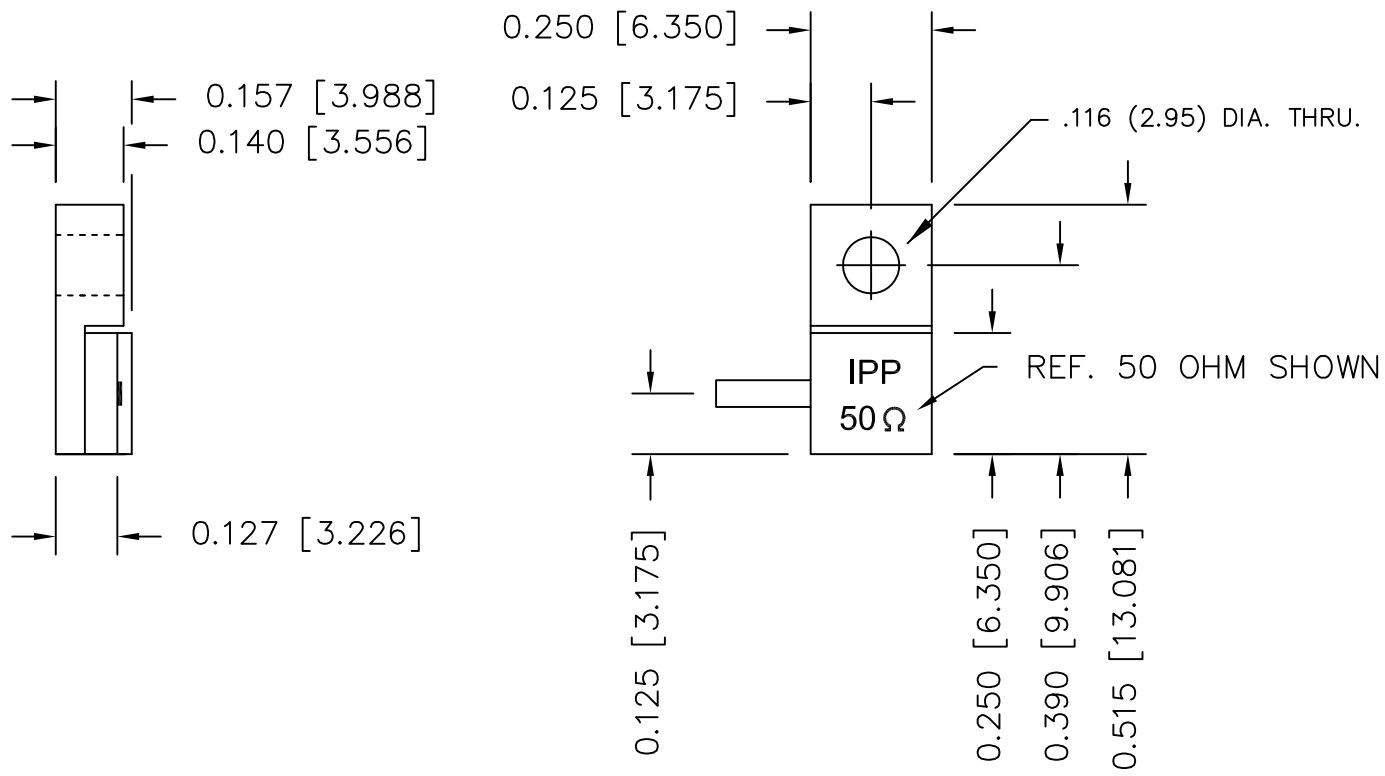

NOTES

- LEAD MATERIAL:
99.99% PURE SILVER,
.040 WIDE x .005 THICK
- LEAD LENGTH: .150 MIN.
- SUBSTRATE MATERIAL: BeO
COVER MATERIAL: Al₂O₃
- FLANGE MATERIAL: COPPER
PLATING: NICKEL

ELECTRICAL SPECIFICATIONS

INPUT POWER: 100 WATT
 FREQ: DC - 5.0 GHZ.
 VSWR: 1.10:1 DC - 4.2 GHZ.
 1.25:1 DC - 5 GHZ.

POWER DERATING CURVE

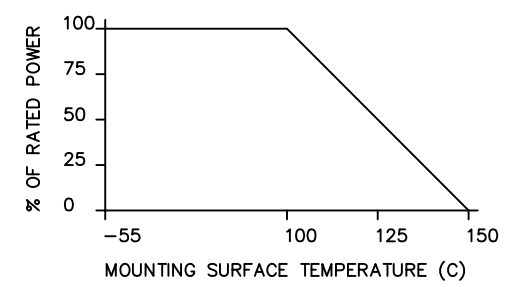

PART NO.	VALUE	TOLERANCE
IPP-TB221-50	50 OHMS	+/- 5%
IPP-TB221-100	100 OHMS	+/- 5%

MATERIAL	[3] [4]	DWN	DG	DATE	8-07		
FINISH	[4]	ENG	TJD	DATE	8-07		
TOLERANCE	.XX ±.02 [.50] IN [MM] .XXX ±.010 [.254]	MANUF	TP	DATE	8-07		
		CAGE CODE: 437R2				TITLE	TERMINATION, 100 WATT, FLANGE
		SHEET	OF	SCALE		P/N	IPP-TB221-XXX
		1	1	4:1		REV.	B