

UNAUTHORIZED USE OF THIS
DRAWING IS STRICTLY PROHIBITED

DAR	REV	DESCRIPTION	APPVD	DATE
1323	A	INITIAL RELEASE	TJD	8-07
1497	B	CHANGE LD HEIGHT & HEIGHT DIMS	DG	11-08

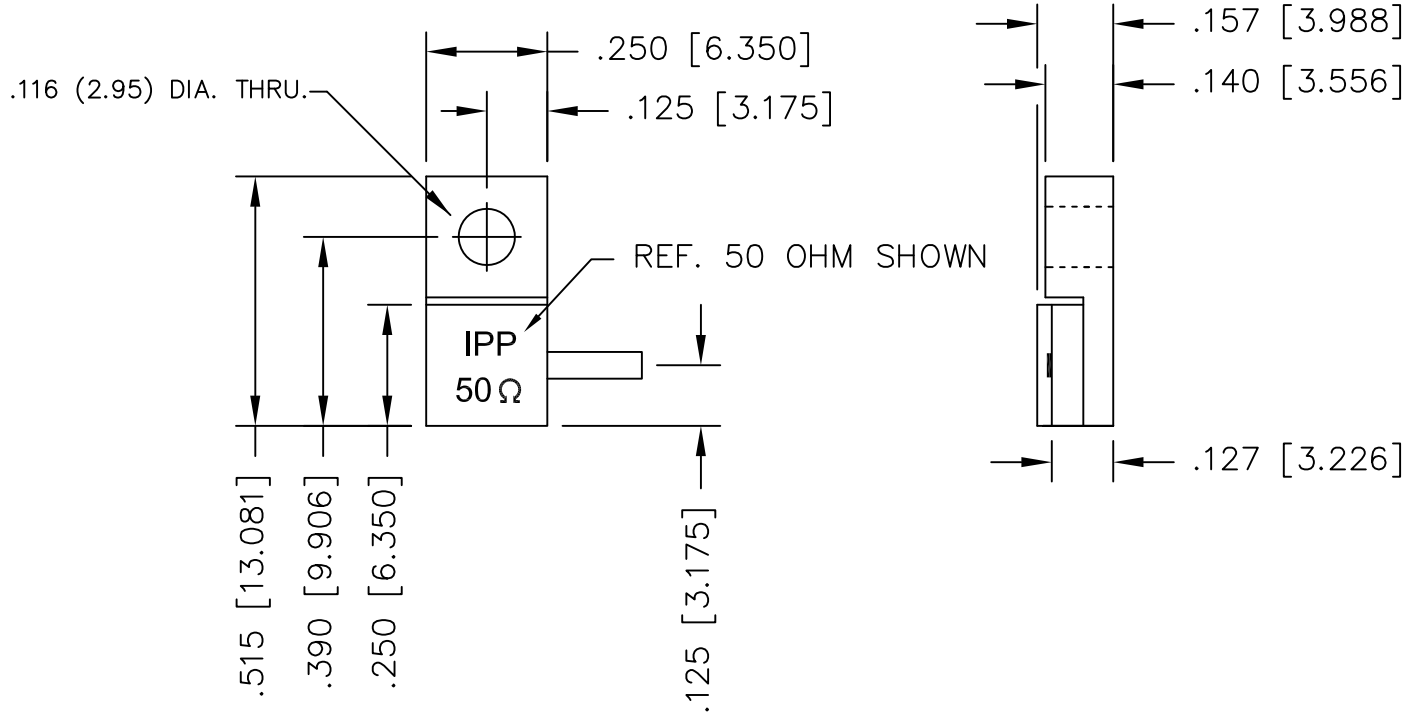

NOTES

1. LEAD MATERIAL:
99.99% PURE SILVER,
.040 WIDE x .005 THICK
2. LEAD LENGTH: .150 MIN.
3. SUBSTRATE MATERIAL: BeO
COVER MATERIAL: Al₂O₃
4. FLANGE MATERIAL: COPPER
PLATING: NICKEL

ELECTRICAL SPECIFICATIONS

INPUT POWER: 100 WATT
 FREQ: DC - 5.0 GHZ.
 VSWR: 1.10:1 DC - 4.2 GHZ.
 1.25:1 DC - 5 GHZ.

POWER DERATING CURVE

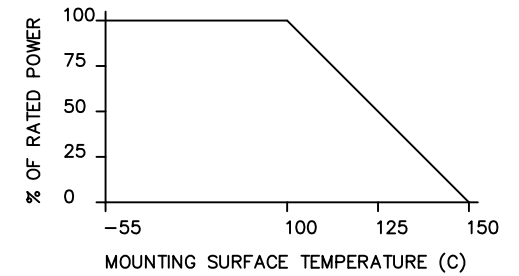

PART NO.	VALUE	TOLERANCE
IPP-TB221R-50	50 OHMS	+/- 5%
IPP-TB221R-100	100 OHMS	+/- 5%

MATERIAL 3 4	DWN DG	DATE 8-07	
	ENG TJD	DATE 8-07	
FINISH 4	MANUF TP	DATE 8-07	TITLE TERMINATION, 100 WATT, FLANGE
	CAGE CODE: 437R2		P/N IPP-TB221R-XXX
TOLERANCE IN [MM] .XX ±.02 [.50] .XXX ±.010 [.254]	SHEET OF 1 1	SCALE 4:1	REV. B